

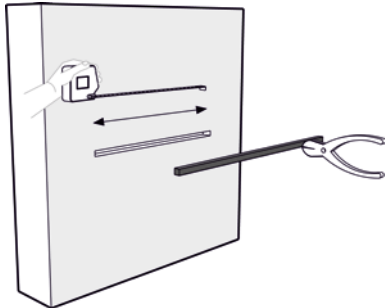

RPI-J Joint seal

APPLICATION MANUAL



1. First measure the required length of the RPI-J Joint seal and if necessary adjust the length before inserting it in the opening.

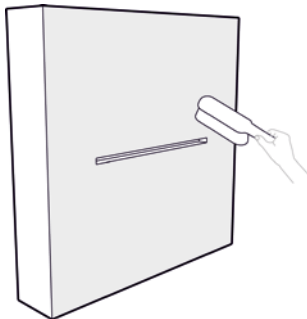

2. Make sure the surface is dry and free of grease and dust.

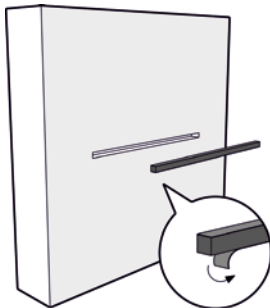

3. Remove the protective layer from the adhesive strip and stick the strip in place.



RPI-J Joint seal

APPLICATION MANUAL

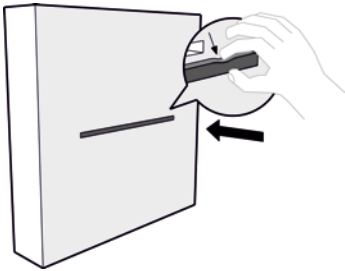

4. The RPI-J Joint seal can be applied pressed together.

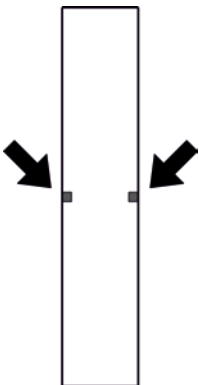

5. Perform steps 1 to 3 for fire resistance of 60 minutes on both sides of the wall.